

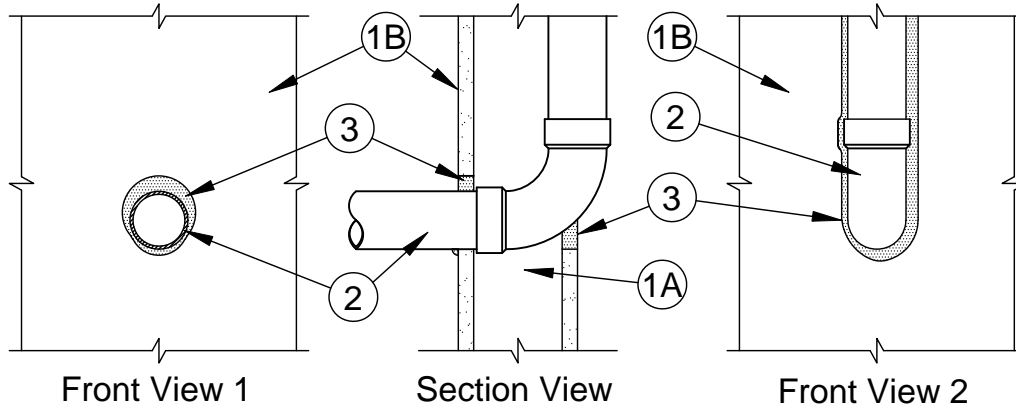

## System No. W-L-1461

F Rating - 1 Hr  
T Rating - 0 Hr



- Wall Assembly** - The 1 hr fire-rated gypsum board/stud wall assembly shall be constructed of the materials and in the manner specified if the individual U300, U400, or V400 Series Wall and Partition Designs in the Fire Resistance Directory and shall include the following construction features:
  - Studs** - Wall framing shall consist of either wood studs or channel shaped steel studs. Wood studs to consist of 2 by 4 in. (51 by 102 mm) lumber spaced 16 in. (406 mm) OC. Steel studs to be min 3-1/2 in. (89 mm) wide spaced max 24 in. (610 mm) OC.
  - Gypsum Board\*** - The gypsum board type, number of layers and sheet orientation shall be as specified in the individual Wall and Partition Design Number.
- Through Penetrant** - Through penetrant installed concentrically or eccentrically within the opening on one side of the wall. Pipe penetrates the membrane continuously in the plane parallel with one surface of the wall. The annular space between the through penetrant and the periphery of the opening shall be min 0 in. (point contact) to max 3/4 in. (19 mm). Through penetrant to be rigidly supported on the through penetration side of the wall assembly. The following types and sizes of through penetrants may be used:
  - Steel Pipe** - Nom 2 in. (51 mm) diam (or smaller) Schedule 10 (or heavier) steel pipe.
  - Iron Pipe** - Nom 2 in. (51 mm) diam (or smaller) cast or ductile iron pipe.
  - Conduit** - Nom 2 in. (51 mm) diam (or smaller) rigid steel conduit or electrical metallic tubing (EMT).
- Fill, Void or Cavity Material\*** - Sealant - A min 5/8 in. (16 mm) thickness of fill material applied within annulus, flush with both surfaces of the wall. At point contact locations between through penetrant and gypsum board, a min 1/4 in. (6 mm) diam bead of fill material shall be applied at the gypsum board/through penetrant interface on both surfaces of the wall.

**SPECIFIED TECHNOLOGIES INC** - SpecSeal Series SSS Sealant, SpecSeal LCI Sealant

\*Bearing the UL Classification Mark



**Specified Technologies Inc. 210 Evans Way Somerville, NJ 08876**

Reproduced courtesy of Underwriters Laboratories, Inc.  
Created or Revised: June 28, 2010

(800)992-1180 • (908)526-8000 • FAX (908)231-8415 • E-Mail:techserv@stifirestop.com • Website:www.stifirestop.com



W-L-1461  
PAGE 1 OF 1